



Table of Contents:

Important Information	2	Changing the Air Filter	8
Product Contents	2	Notes	8
Installation Instructions	3-7		

IMPORTANT INFORMATION:

Please read these instructions thoroughly before use. Failure to follow instructions may result in equipment damage or failure, losses, injury or death.

⚠ **WARNING:** ⚠

To reduce the risk of electric shock or injury:

- ALWAYS unplug the compressor from power source and remove pressure from airlines before installing the maintenance kit.

IMPORTANT: Airmax® is not responsible for equipment damage or failure, losses, injury or death resulting from failure to follow safety precautions, misuse or abuse of equipment.

PRODUCT CONTENTS:

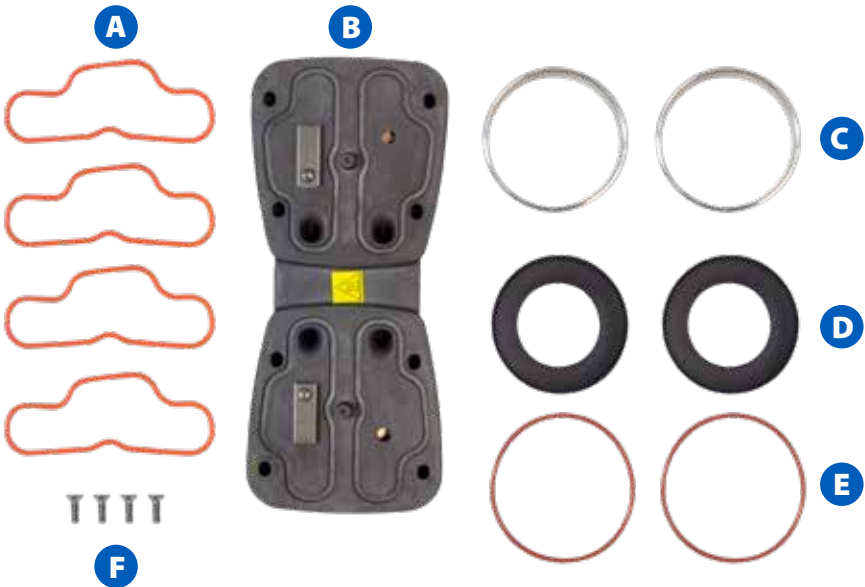

What's Included:

- A** 4 Head O-Rings
- B** Valve Plate with Pre-Installed Leaf Valves
- C** 2 Cylinder Sleeves
- D** 2 Piston Cups
- E** 2 Cylinder O-Rings
- F** 4 Torx Head Screws

INSTALLATION INSTRUCTIONS:



See Video Instructions of the G50 (RP50 87R) Maintenance Kit installation online at airmaxeco.com/InstallRP50

Tools Required:

- T25 Torx Wrench
- T20 Torx Wrench
- 5/32" Allen Wrench
- 1/4" Nut Driver

Step 1

Using a 5/32" Allen wrench, remove the two screws holding down the compressor manifold.



Step 2

Remove and save the two spacers underneath the manifold.



Step 3

Using a T25 Torx wrench, remove the remaining six screws on the top of the head assembly.

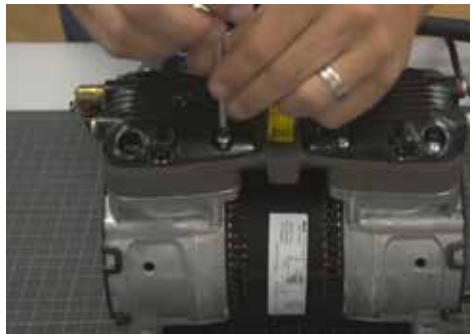

Step 4

Separate the heads from the valve plate assembly and set aside. Note the positions of the leaf valves on the valve plate in relation to the capacitor. This positioning will be important when reinstalling the new valve plates.

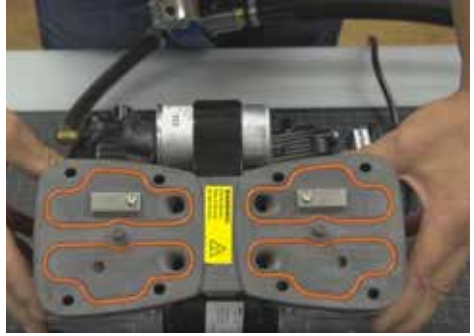

Step 5

Remove the capacitor from the capacitor clamp. Then remove the two screws from the clamp using a 1/4" nut driver. Set aside clamp and screws.

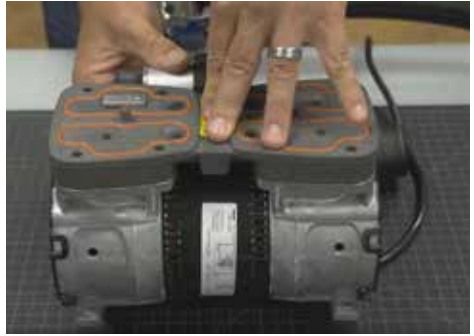

Step 6

Using a T20 Torx wrench, remove the two set screws on the piston retainer plate for both cylinders.



Step 7

Remove and discard the worn cylinder sleeves and piston cups. The piston retainer plates will be reused.



Step 8

Place the retainer plate into a new piston cup making sure that the lip of the piston cup faces up.



Step 9

Place the retainer plate and piston cup onto the cylinder sleeve. Firmly push the retainer plate into the sleeve. Flip over to ensure the piston cup is evenly aligned.



Step 10

Place the cylinder sleeve into the grooves on top of the compressor body and align the holes for the piston retainer plate. Use two new screws supplied with the maintenance kit to reinstall the piston cups (**Recommended Torque: 34-38 in lb**).



Step 11

Repeat Steps 8-10 for the second cylinder.

Step 12

Reinstall the capacitor clamp on the new valve plate using the original screws and a 1/4" nut driver.

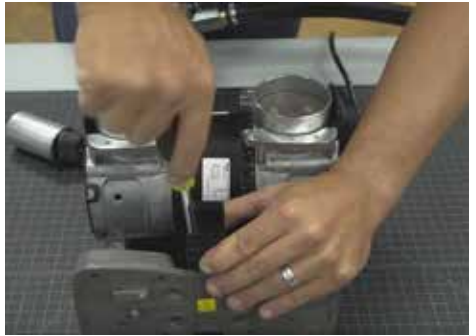

Step 13

Flip the valve plate over to install the two new cylinder o-rings.



Step 14

Install the valve plate onto the cylinder sleeves ensuring the leaf valves are on the same side as the capacitor. Push down firmly to secure in place.



Step 15

Install the four new head o-rings from the maintenance kit into the grooves on the top of the valve plate.



Step 16

Align the head covers on top of the valve plates. Match the grooves in the head to the grooves in the valve plate. Not doing so will damage the leaf valves.



Step 17

Install the six screws to secure the head covers on the valve plate. Leave the inner two screw holes open. We recommend going back and forth between screws to ensure the screws are securely in place. Be sure not to over tighten (**Recommended Torque: 47-50 in lb**).



Step 18

Reposition the two spacers onto the two remaining holes in the head assembly and secure with the two remaining screws using a 5/32" Allen wrench. Be sure to go back and forth to ensure the screws are securely in place.



Step 19

Press the capacitor back into the capacitor clamp.



Changing the Air Filter:



Changing the air filter should be done every 3-6 months

To replace the air filter, hold the base of the air filter and turn the top counterclockwise to remove the air filter cap. Replace the old air filter element with a new one.

NOTES

THANK YOU FOR CHOOSING:

Airmax, Inc.

15425 Chets Way Street
Armada, MI 48005

866-424-7629
www.airmaxeco.com

#510521 V2.1